

SET UP GOOGLE ASSISTANT VOICE CONTROL WITH THE OSRAM LIGHTIFY GATEWAY

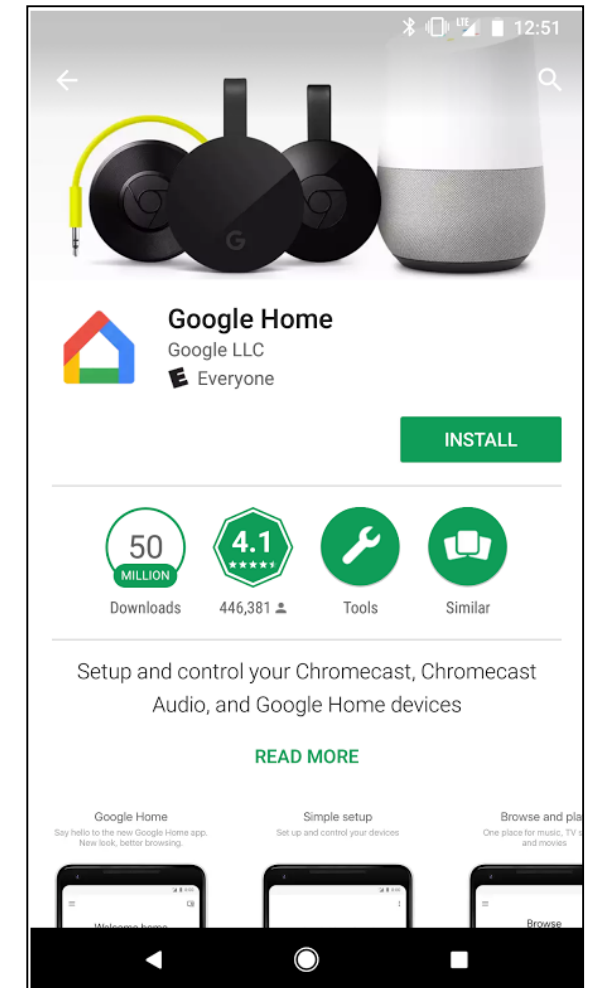

Step 1 Download the Google Home App

- Search for the **Google Home** App in App Store (iOS) or Play Store (Android).
- If you already have the Google Home app and a Google Home device connected, skip to step 4.

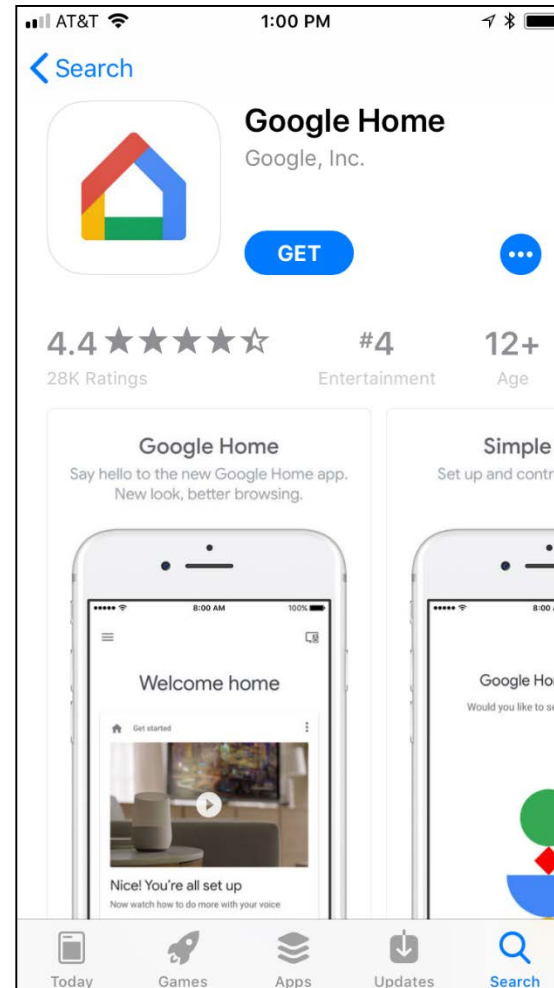

Step 2 Connect your Google Home Device

- The first time you open the Google Home app, you will be prompted to connect your Google Home device.
- If not, select the **Menu > Devices** to connect your Google Home.
- If you have multiple Google accounts connected to your phone, make sure to select the correct one.
- Follow the prompts on the welcome screen to Get Started.

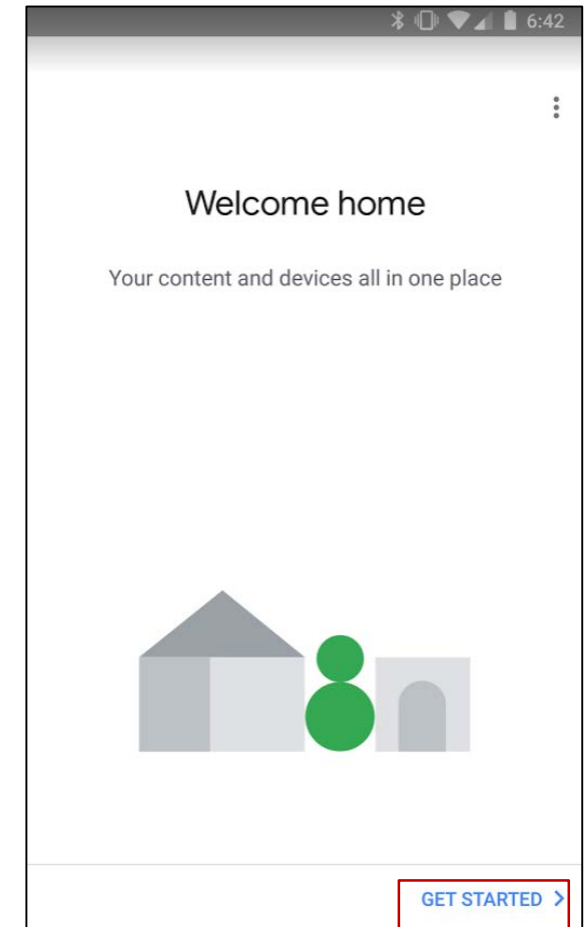
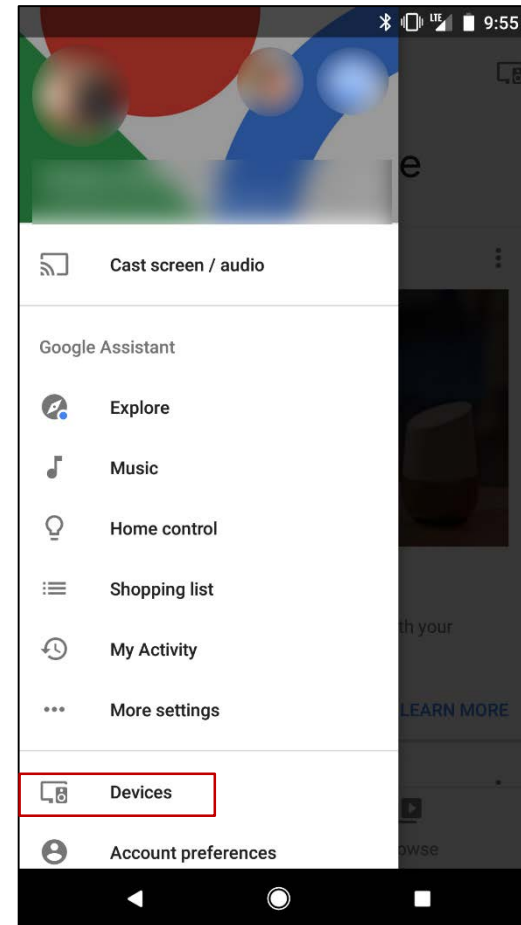

Step 3 Link your Gateway to Google Home

- With your Google Home device connected, on the main screen tap the **Menu** icon.
- Select **Home Control**
- Select the **Plus Sign (+)** in the bottom right hand corner to add a new smart home device.

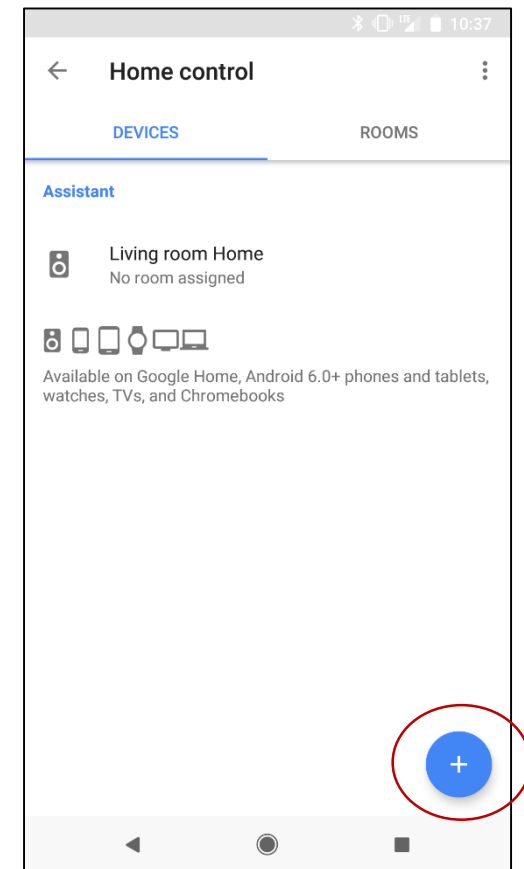
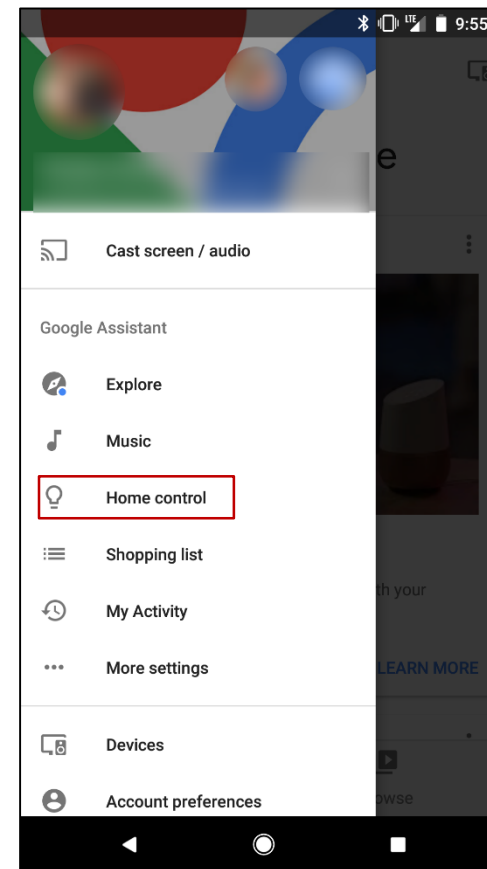

Step 4 Connecting Your Gateway

- Search for OSRAM Lightify North America and select it from the list.
- Enter the same email and password you use to log in to the LIGHTIFY app.
- Select **Approve**. Google Home will now be able to communicate to your LIGHTIFY Gateway.

