

sell-even

BUILDING PRODUCTS

A DIVISION OF APPLETON SUPPLY. A GIBRALTAR INDUSTRIES COMPANY.

Aluminum Siding System

Do It Yourself
Installation Guide



***For New Construction
and Remodeling***

The Sell-Even Aluminum Siding System is manufactured to professional tolerances, yet it's designed to be fast and easy to install for the "do it yourself".

Tools Needed

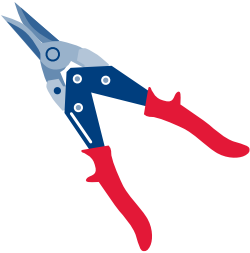
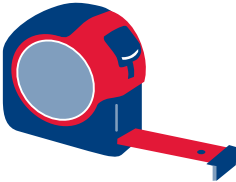

8" Hollowback Rough-Sawn

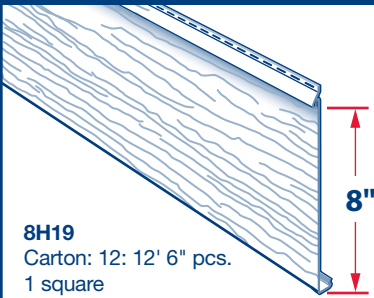

Brown - 1579352

White - 1579307

Tan - 1579365

Slate - 1579323

Gray - 1579310

8" Foamback Rough-Sawn

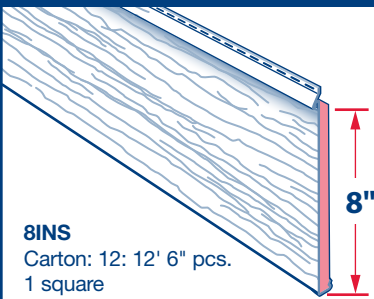

Brown - 1579556

White - 1579501

Tan - 1579569

Slate - 1579527

Gray - 1579514

Double 4" Hollowback Rough-Sawn

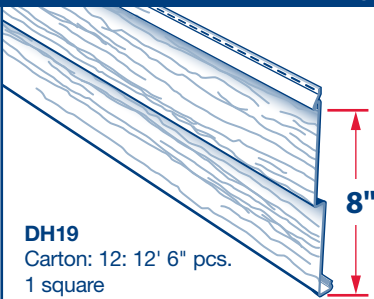

Brown - 1579255

White - 1579200

Tan - 1579268

Slate - 1579226

Gray - 1579213

Double 4" Foamback Rough-Sawn

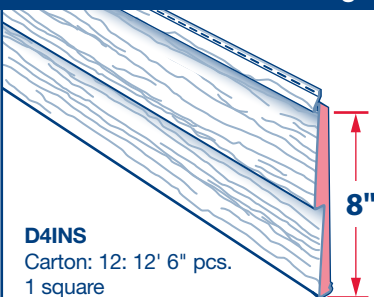

Brown - 1579459

White - 1579404

Tan - 1579462

Slate - 1579420

Gray - 1579417

Drop-in Polystyrene - 8"

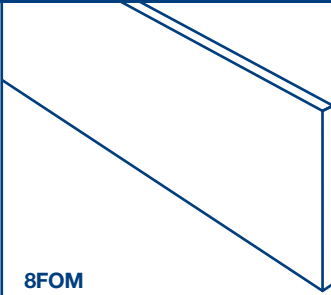

White - 1579747

8FOM

Drop-in Polystyrene - Double 4"

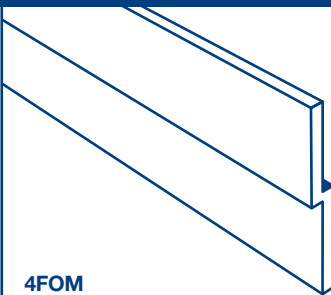

White - 1579721

4FOM

J Channel - Smooth

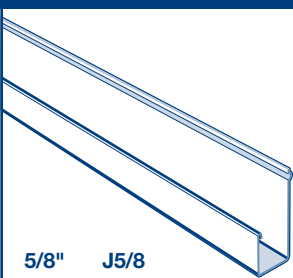

5/8" J5/8
1 1/8" J18

	5/8"	1 1/8"
1577684	Brown	1577927
1577626	White	1577862
1577707	Tan	1577862
1577723	Slate	1577969
1577642	Gray	1577888

Aluminum Starter Strip

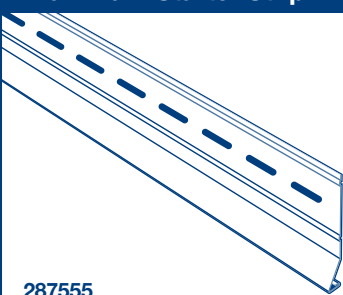

Mill - 1577600

287555

1" Outside Corner Post - Rough-Sawn

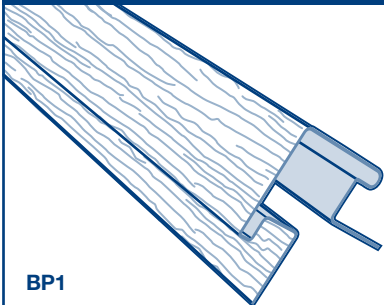

Brown - 1578285

White - 1578227

Tan - 1578308

Slate - 1578324

Gray - 1578243

1" Inside Corner - Smooth

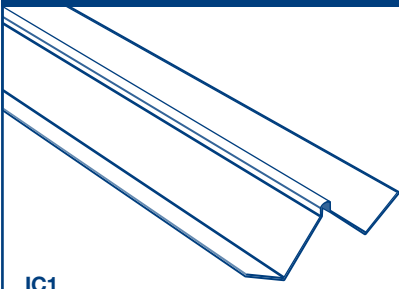

Brown - 1578528

White - 1578463

Tan - 1578544

Slate - 1578560

Gray - 1578489

Undersill Trim - Smooth

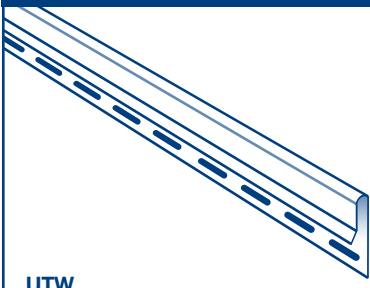

Brown - 1578049

White - 1577985

Tan - 1578065

Slate - 1578081

Gray - 1578007



A DIVISION OF APPLETON SUPPLY. A GIBRALTAR INDUSTRIES COMPANY. 

New Construction: Check to see that all nails and sheathing are in place.

Re-Siding: Secure and nail loose boards. Remove down spouts, lighting fixtures, mouldings, old caulking around windows and doors. Check to see that sidewalls and base are level and plumb. Use furring where necessary.

One carton of hollowback siding contains enough material to cover 100 square feet of wall area.

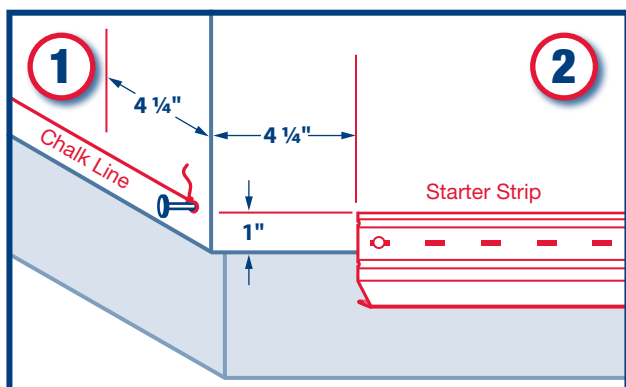

1. ESTABLISH CHALK LINE

Establish a chalk line in relation to the windows and eave after determining the lowest corner of the house. Partially drive a nail 1" above the lowest point and snap a level chalk line from this nail to a similar nail at the next corner. Repeat same procedure around house.

When installing siding leave a minimum of 6" clearance from soil grade or 2" from a hard surface such as steps, driveways and decking products. Flashing and counter flashing is required at roof/wall junctures, in accordance with the roofing manufacturers instructions. Siding must be installed with a minimum 2" clearance from roofing or as per the local building code.

2. INSTALL STARTER STRIP

Align the top of starter strip on the chalk line. Nail the starter strip with corrosion resistant fasteners 12" o.c., **snug-not-tight**. When using backerboard insulation or insulated sheathing behind siding, fur out the starter strip to accommodate the additional thickness. At a minimum, a weather resistant barrier or housewrap should be installed over wood fiber wall sheathing.

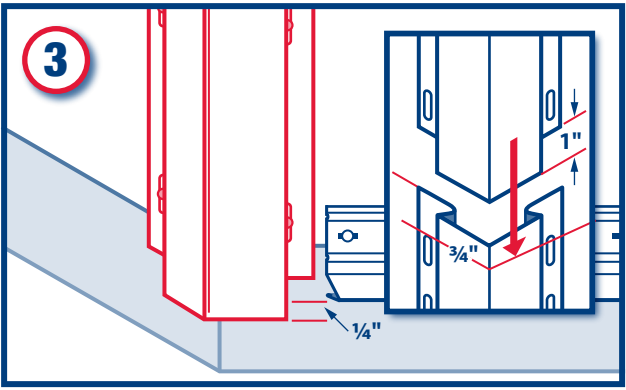

3. INSTALL CORNER POSTS

To install all corner posts. Place bottom edge of post 1/4" below the bottom of the starter strips. Corner posts should run straight and true up the wall to the eave. Nail to the adjoining walls.

SPLICING CORNER POSTS

Splicing is necessary when the corner post does not reach the desired height. Working on the bottom edge of the upper post, cut 1" of the nailing flanges away. Lap the top post over the bottom post 3/4" to allow for expansion and contraction.



SIDING IS HUNG, NOT NAILED.

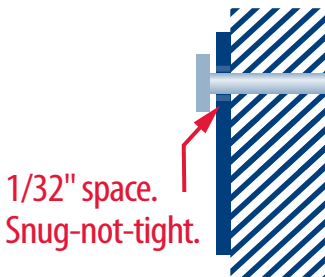
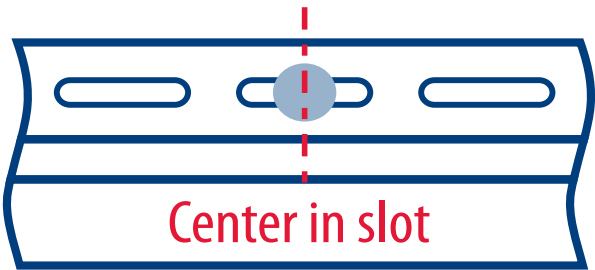

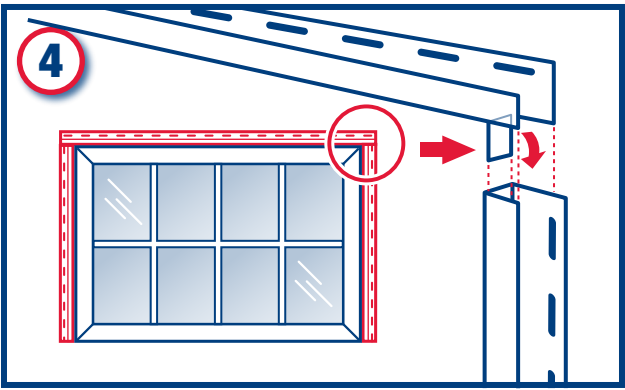

4. INSTALL "J" CHANNEL TO TOP AND SIDES OF WINDOWS AND DOORS

Nail J Channel flush to the top and sides of doors and window casings, following nailing instructions.

FORMING CORNERS WITH "J" CHANNEL

Install top J Channel so that it extends beyond the casings a distance equal to the width of the side J Channels. Make two cuts in the base of the top J Channel and bend the base down. The bent portion will slide over the side J Channel and make a water drain. Prior to installing the J Channel to the wall a 3/8" bead of high quality urethane caulk should be used behind the J Channel and Undersill Trim to prevent water infiltration between the window or door opening and the J Channel and Undersill Trim.

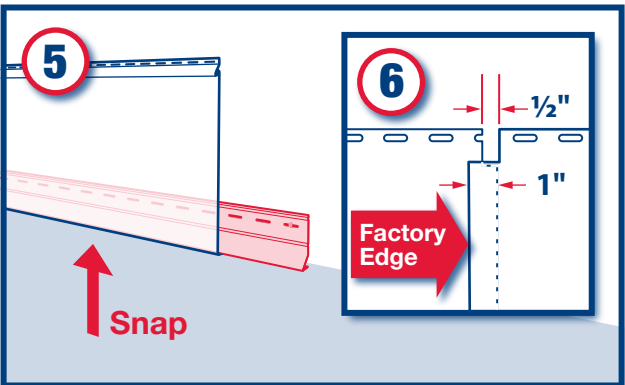

5. INSTALL FIRST SIDING PANEL

Install siding panels working from the outside corner or the termination point on the wall toward the center of the wall. This will make seam less apparent from door opening which tend to be a focal point of visual concern. Aluminum siding nails should be used to install you new siding components. Nail length equals the thickness of the wall sheathing plus an 1 1/2" into solid framing members.

6. OVERLAP PANELS

Each panel should overlap previous panel 1/2" or half the width of the factory notch to allow for movement in the siding. Always lap the factory end over any end you have cut. Lap all joints away from doors.

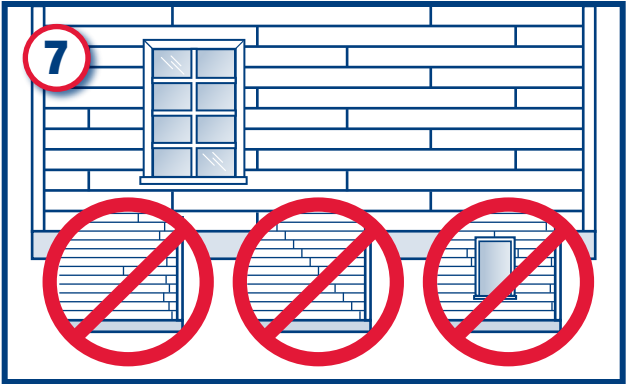

7. INSTALL BALANCE OF SIDING

After completing first row of siding, continue with second row, starting each row at the back of the house, working to the front. Stagger the lengths of siding as you work so that the joint from the lower panel does not line up nor is it near the panel above.

8. SIDING UNDER WINDOWS

Fitting siding panels under windows usually requires cutting a panel.

MEASURE SPACE UNDER WINDOW

Hold a piece of siding under the window. Measure and mark on the siding the width of the opening under the window. Lock a piece of scrap siding into the panel below and hold it beside the window. Measure and mark the vertical space on the panel, leaving 1/4" space below the windowsill.

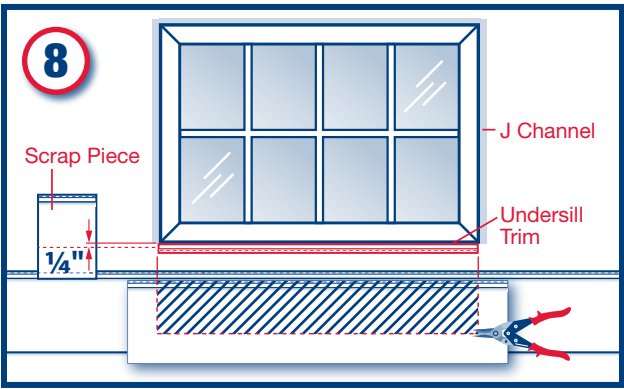

CUT SIDING TO FIT UNDER WINDOW

Using these measurements, mark the area of the siding to be removed. Make vertical cuts in the top of the siding. Use a tin snips to make the horizontal cut and pop the piece out.

INSTALL SIDING UNDER WINDOW

Install undersill trim the width of the window flush to the casing. Furring may be necessary to maintain proper pitch of the siding. Nail the correct thickness of furring under the sill and install undersill trim over it with aluminum nails close up under the sill for a tight fit.

SIDING ABOVE WINDOWS

Use the same measuring procedure to fit siding above windows. Cut from the bottom of the siding and drop into the J Channel above window.

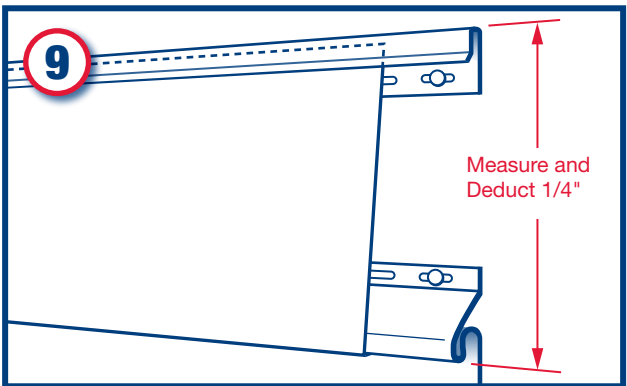

9. FINISHING TOP ROW OF SIDING UNDER EAVES

The procedure for finishing top row of panels under eaves is similar to fitting panels under windows. Usually furring will be needed under this last panel to maintain correct slope angle. Nail undersill trim to the furring with aluminum nails. Trim should extend the entire length of the wall.

MEASURE SPACE UNDER EAVE

Measure the distance from the top inside slot of the undersill trim to the lock or the bottom of the panel below and cut the edge into the undersill trim. Prior to installing the undersill trim to the wall a 3/8" bead of high quality urethane caulk should be used behind the undersill trim to prevent water infiltration damaging the wall sheathing.

INSTALL SIDING UNDER EAVE

Lock the bottom of the siding to the panel below and the cut edge into the undersill trim.

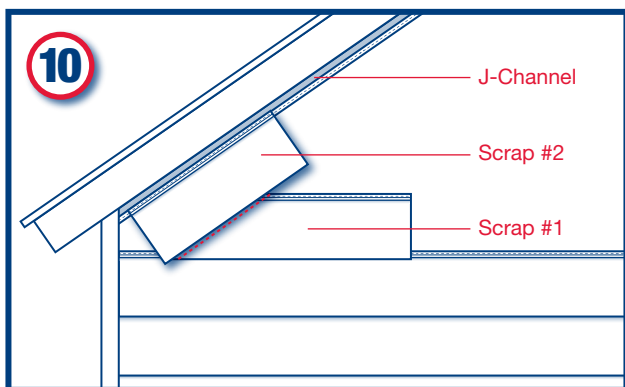

10. SIDING UNDER GABLE

Install J Channel flush against the gable. Measure the angle of the gable by taking one scrap panel and interlocking it with panel below so that an upper corner touches the J Channel running up the gable. Take a second scrap panel, place into J Channel and hold over the first panel. Mark a line along the angle where the panels overlap. This will be the pattern for cutting the end of the siding to be installed under one side of the gable. Measure again for the correct angle on the other side of the gable by following the same procedure. Install siding panels with the ends cut to the angle of the gable.



FEATURES

Top Quality Aluminum

This complete aluminum siding system is made from sturdy, low maintenance aluminum. The 8 inch and Double 4 inch panels are woodgrain embossed for rugged beauty and additional strength. The aluminum will never rust, rot or split. Quality made and color coordinated accessories are also available.

Rugged Good Looks

A complete system to cover your whole house or just dress up an addition or garage. Interlocking panels come in beautiful colors to seal out the weather, while giving your home bright good looks that will last for years and years.

Low Maintenance

Once installed, only minor maintenance will be required for years of trouble free service. No need for periodic repainting.

Limited Lifetime Warranty



SELL-EVEN BUILDING PRODUCTS

A Division of Appleton Supply Co., Inc.

1905 W. Haskell Street, Appleton, WI 54914 • 800-558-3414