

PERFORMAXTM

MENARDS[®]

© 2020 Menard, Inc., Eau Claire, WI 54703

06/2020

PERFORMAXTM

Passive Welding Helmet



242-1457

OPERATOR'S MANUAL

CAUTION: To Reduce The Risk Of Injury, User Must Read And Understand Operator's Manual. Save These Instructions For Future Reference.

Customer Service: 1-855-692-6872 Distributed by Menard, Inc. Eau Claire, WI 54703

TABLE OF CONTENTS

SAFETY SYMBOLS	Page 1
OPERATION	Page 3
OVERVIEW	Page 4
MAINTENANCE	Page 4
TEMAINTENANCE	Page 5
INSPECTION	Page 6

SAFETY SYMBOLS

WARNING

Read and understand this entire instruction manual before attempting to assemble, install, operate or maintain this tool. Failure to comply with the instructions may result in serious personal injury and/or property damage!

The following signal words are used to emphasize safety warnings that must be followed when using this tool:

 **DANGER:** Indicates an imminently hazardous situation that, if not avoided, WILL result in death or serious injury.

 **WARNING:** Indicates a potentially hazardous situation that, if not avoided, COULD result in death or serious injury.

 **CAUTION:** Indicates a potentially hazardous situation that, if not avoided, MAY result in minor or moderate injury.

 **NOTICE:** Indicates important information, which if not followed, MAY cause damage to equipment.

IMPORTANT SAFETY INSTRUCTIONS **FUMES AND GASES can be hazardous !**

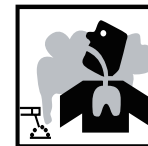

- Welding produces fumes and gases that are hazardous to your health.
- Keep your head out of the fumes. Do not breathe in the fumes.
 - If inside, ventilate the area and/or use exhaust at the arc to remove welding fumes and gases.
 - If ventilation is poor, use an approved air-supplied respirator.
- Read the manufacturer' s instructions for metals, consumables, coatings, cleaners, and degreasers.
 - Work in a confined space only if it is well ventilated, or while wearing an air-supplied respirator. Always have a trained watchperson nearby. Welding fumes and gases can displace air and lower the oxygen level causing injury or death. Be sure the breathing air is safe.
 - Do not weld in locations near degreasing cleaning, or spraying operations. The heat and rays of the arc can react with vapors to form highly toxic and irritating gases.
 - Do not weld on coated metals, such as galvanized, lead, or cadmium plated steel, unless the coating is removed from the weld area, the area is well ventilated, and if necessary, while wearing an air-supplied respirator. The coatings and any metals containing these elements can give off toxic fumes if welded.

SAFETY SYMBOLS

ARC RAYS can burn eyes !



Never look at arc welding without proper eye protection. Arc rays from the welding process produce intense visible and invisible (ultraviolet and infrared) rays that can burn eyes and skin. Hot sparks fly off from the weld and can burn eyes and skin.

Wear a welding helmet fitted with a proper shade of filter to protect your face and eyes when welding or watching.

- Wear approved safety glasses with side shields under your helmet.
- Use protective screens or barriers to protect others from flash and glare, warn others in the area not to watch the arc.
- Wear protective clothing made from durable, flame resistant materials, leather welding gloves and full foot protection.

WELDING can cause fire or explosion !



Welding on closed containers, such as tanks, drums, or pipes, can cause them to explode. Sparks can fly off from the welding arc. The flying sparks, hot work piece, and hot equipment can cause fires and burns. Accidental contact of electrode to metal objects can cause sparks, explosion, overheating, or fire. Check and be sure the area is safe before doing any welding.

- Always keep a fire extinguisher readily available and watch for fire.
- Protect yourself and others from flying sparks and hot metal.
- Do not weld where flying sparks can strike flammable material.
- Remove all flammable materials from the welding area. If this is not possible, tightly cover them with approved covers.
- Be alert that welding sparks and hot materials from welding can easily go through small cracks and openings to adjacent areas.
- Be aware that welding on a ceiling, floor, bulkhead, or partition can cause fire on the hidden side.
- Do not weld on closed containers such as tanks, drums, or pipes; unless they are properly prepared according to AWS F4.1 standards.
- Connect work cable to the work as close to the welding area as practical to prevent welding current from traveling long, possibly unknown paths and causing electric shock and fire hazards.
- Never use arc welder to thaw frozen pipes.
- Remove electrode from holder when not in use.
- Wear oil-free protective garments such as leather gloves, heavy shirt, trousers with no cuffs, high shoes, and a cap.
- Remove any combustibles, such as butane lighters or matches, from yourself and the surroundings near the welding location before doing any welding.

California Proposition 65 Warnings !

- Welding or cutting equipment produces fumes or gases which contain chemicals known to the State of California to cause birth defects and, in some cases, cancer. (California Health & Safety Code Section 25249.5 et seq.)

SAFETY SYMBOLS

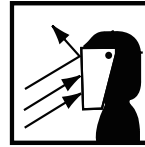

FLYING METAL can injure eyes !

- Welding, chipping, wire brushing, and grinding cause sparks and flying metal. As welds cool, they can throw off slag.
- Wear ANSI approved safety glasses with side shields under your welding helmet.

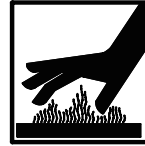

HOT PARTS can cause severe burns !

- Never touch hot parts bare handed.
- Allow adequate cooling period before touching work piece.



NOISE can damage hearing !

- Noise from some processes or equipment can damage hearing.
- Wear approved ear protection if noise level is high.

GENERAL INFORMATION

The Passive Welding Helmet DOES NOT protect against severe impact hazards, such as broken grinding wheels or abrasive discs, explosive devices or corrosive liquids. Machine guards or eye splash protection must be used when these hazards are present.

The Passive Welding Helmet is suitable for all Arc welding processes such as MIG, MAG, TIG, SMAW, Plasma Arc, and Carbon Arc.

The Passive Welding Helmet is NOT recommended for "Overhead" welding applications, Laser welding or Laser cutting applications.

Protection will be seriously impaired if unapproved modifications are made. Always be used with original inner and outer cover lenses.

OPERATION

ADJUST THE WELDING HELMET ACCORDING TO YOUR INDIVIDUAL REQUIREMENTS.

The headband should be adjusted both in circumference and height.

The angle between face and helmet should also be adjusted and recommended to be 10°-12°. (Fig.1).

Fig.1

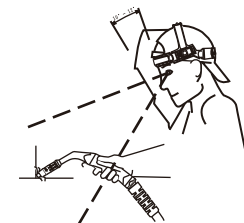

OVERVIEW

PARTS LIST

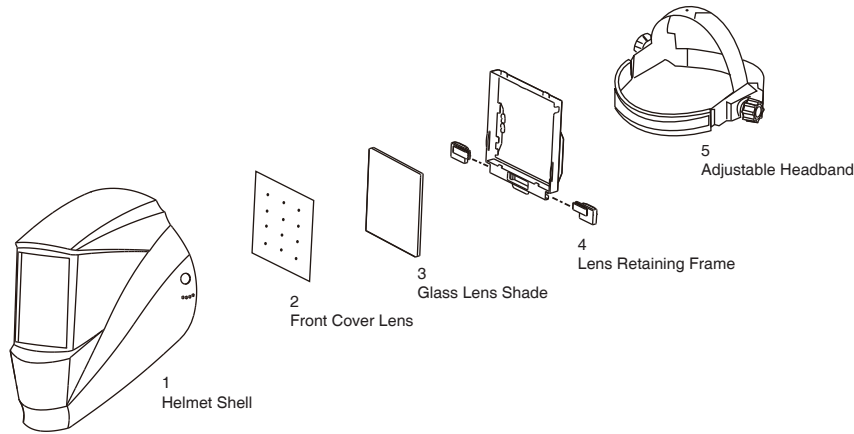

MAINTENANCE

REPLACEMENT OF FRONT COVER LENS.

Remove the front lens by pulling out the retaining frame. (Fig.2)
Take out the old cover lens.

Fig.2

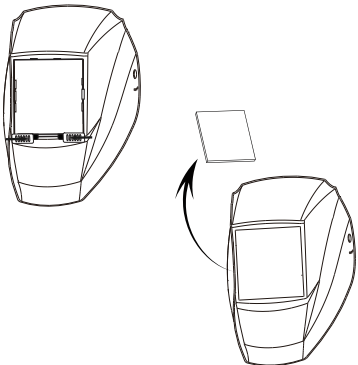

Make sure that the protective film is removed from the new cover lens. Place the new cover lens in the recess at the front of the helmet. (Fig.3)

⚠ NOTICE:

DO NOT use the helmet without the cover lens in place.

Fig.3



TE MAINTENANCE

REPLACEMENT OF FILTER PLATE

Remove the mounting brackets from both sides of the filter plate. Replace the old filter plate and install a new filter plate in the front lens retaining frame. Re install mounting brackets (Fig.4).

Fig.4

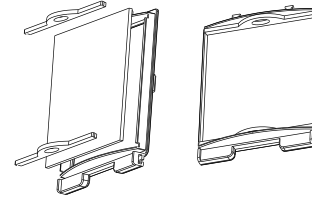
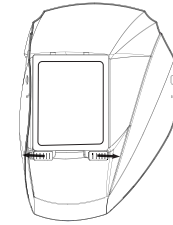

Fig.6



OPERATION

Adjust headband per personal preference. Adjust helmet's headband stop to get desired viewing angle. (Fig.7)

Fig.7

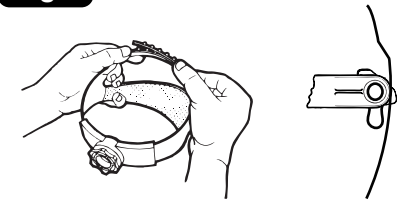

INSTALL

Insert tabs of the front lens retaining frame under the two slots of the back lens retaining frame. Push the two corners on front lens retaining frame until it snaps into place. (Fig.5)

Fig.5

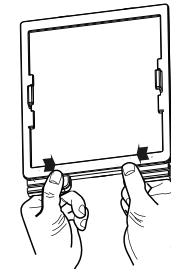

Insert the magnifying lens

- 1) Magnifying lens is sold separately.
- 2) Insert the magnifying lens into the slot from the top to the bottom (Fig.8).

Fig.8

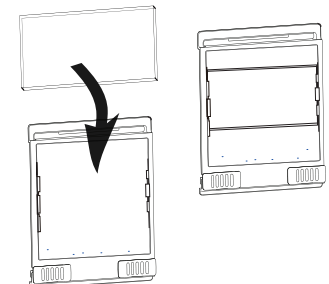

Insert tabs of the back lens retaining frame under the two slots of the helmet. Push the locking mechanism until it snaps into place. (Fig.6)

⚠ WARNING:

DO NOT use the helmet and lens unless they are fully assembled.

NOTES



**Passive Welding Helmet
WARRANTY**

2-YEAR LIMITED WARRANTY

The passive welding helmets are warranted against defects in materials and workmanship for a period of two (2) years from date of purchase.

This warranty is limited to the repair or replacement of items which are not in compliance with this warranty. This warranty does not extend to any item subject to unauthorized repair, alteration, tampering, improper storage or operation, inadequate maintenance, accident, misuse, abuse or negligent handling. This warranty is not transferrable from the original purchaser to any subsequent purchaser.

Seller shall in no event be liable or responsible for any injury, damage or loss resulting either directly or indirectly from, the use or misuse of this product.

This limited warranty is the exclusive remedy of purchaser and the sole obligation of Seller in connection with any claim, whether in contract, negligence, strict liability, tort or otherwise.

Do not use these items unless you are trained and experienced in the proper use and maintenance. Please read the instruction manual carefully to avoid certain situations which may void this limited warranty.

Customer Service: 1-855-692-6872

Distributed by Menard, Inc. Eau Claire, WI 54703

**SAVE YOUR RECEIPTS
THIS WARRANTY IS VOID WITHOUT THEM**